

UX-50-P INSTALLATION

IP 68 UNDERWATER LED STAINLESS STEEL LIGHT FIXTURE

READ AND FOLLOW INSTRUCTIONS CAREFULLY



THE UX-50 series are a low voltage light and should NEVER be electrically connected to a power source other than approved UL listed outdoor rated class 2 Transformer.
Failure to comply will either damage or destroy UX-50 lights and void the warranty.



1. Insert Into Fitting

1.5" pipe through bond beam for a minimum of 14" then 1" conduit minimum with sweeps / no 90° bends. We highly recommend the use of a 1.5" pipe throughout the entire width of the bond beam.

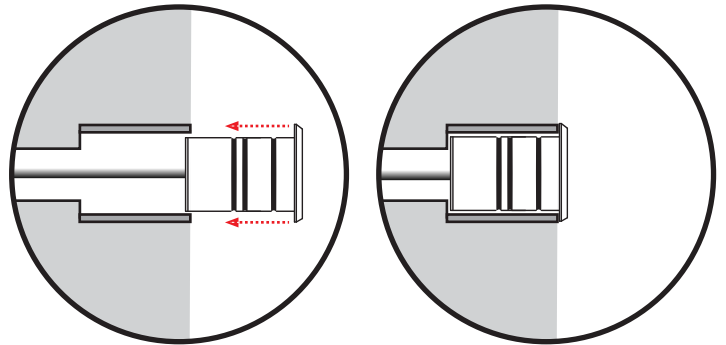

2. Feed Through Conduit Outlet

Snake the electric cord through the conduit outlet of the wall fitting into the conduit and up to the location of the 12VC constant current power supply. Cut off excess cord after allowing for service and length of run to the transformer. Pull the fixture snug to the wall fitting. 18"- 24" of excess cord recommended as service loop.

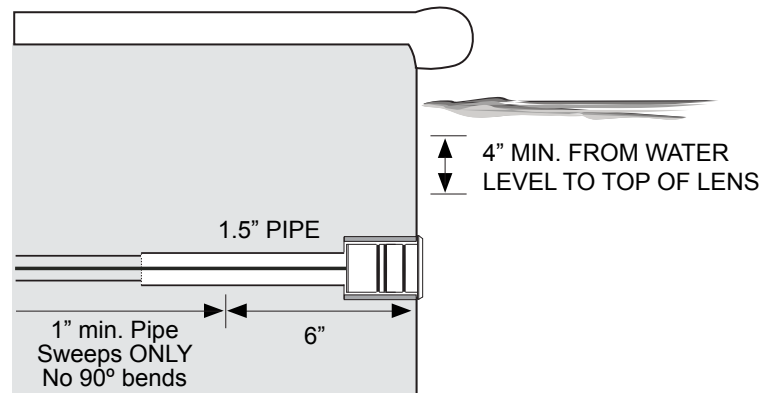

2. Press Firmly

Press Fixture firmly into Conduit. Rubber O-rings will self seal and lock into place.

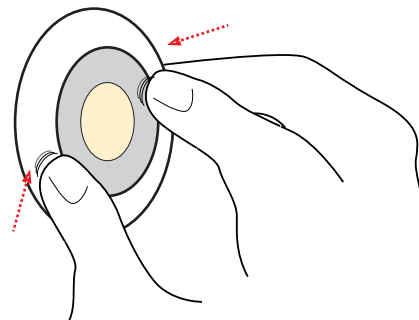

3. Connect to Controller and/or Power Supply

(See wiring diagrams)

IMPACT LIGHTING

2101 West Central Blvd. Orlando, Florida 32805 USA • Phone: 1.800.507.5714 • Email: sales@impactlightinginc.com

www.impactlightinginc.com

UX-50-P WIRING DIAGRAM

IP 68 UNDERWATER LED STAINLESS STEEL LIGHT FIXTURE

Connecting to Constant Current Power Supply

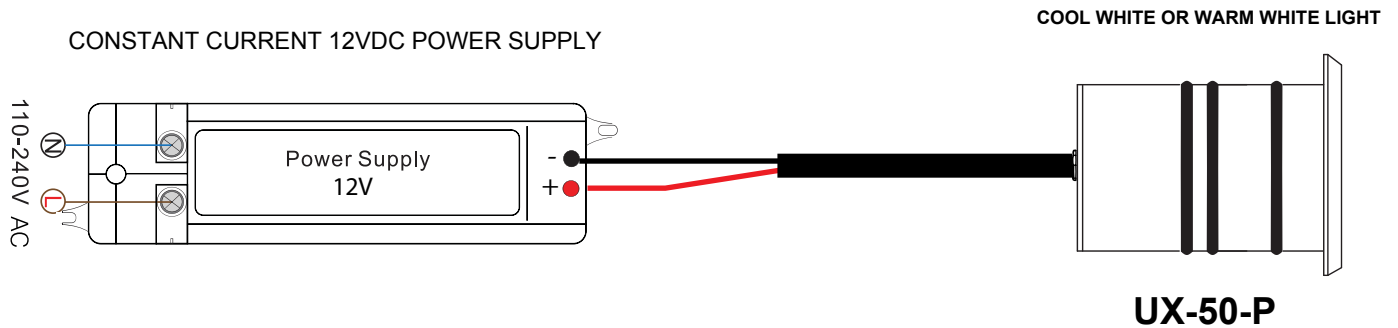

Connecting to DMX and Constant Current Power Supply

DMX SYSTEM WIRING

UX-50-1023-RGB-DMX
UX-50-1023-RGBW-DMX
UX-50-1023-WW-CW-DMX

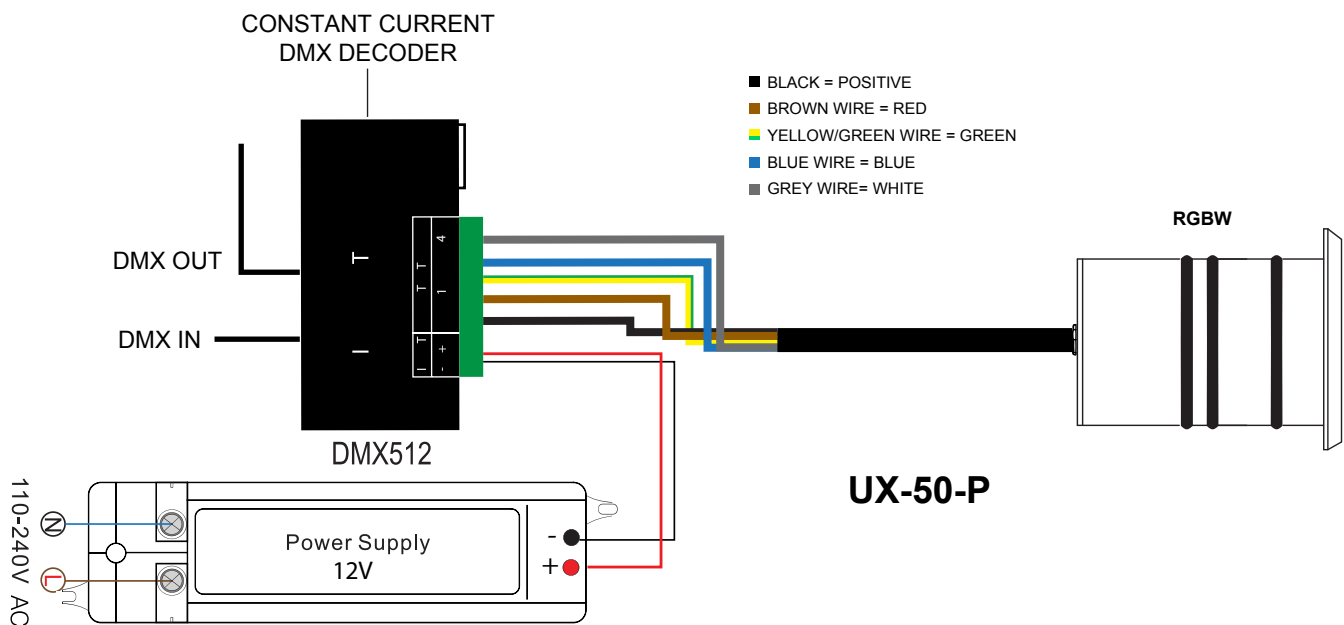

IMPACT LIGHTING

2101 West Central Blvd. Orlando, Florida 32805 USA • Phone: 1.800.507.5714 • Email: sales@impactlightinginc.com

www.impactlightinginc.com

UX-50-T INSTALLATION

IP 68 UNDERWATER LED STAINLESS STEEL LIGHT FIXTURE

READ AND FOLLOW INSTRUCTIONS CAREFULLY



THE UX-50 series are a low voltage light and should NEVER be electrically connected to a power source other than approved UL listed outdoor rated class 2 Transformer.
Failure to comply will either damage or destroy UX-50 lights and void the warranty.



1. Place in Water Feature

The UX-50 with tripod can be placed and mounted in practically any water feature fully or partially submerged.

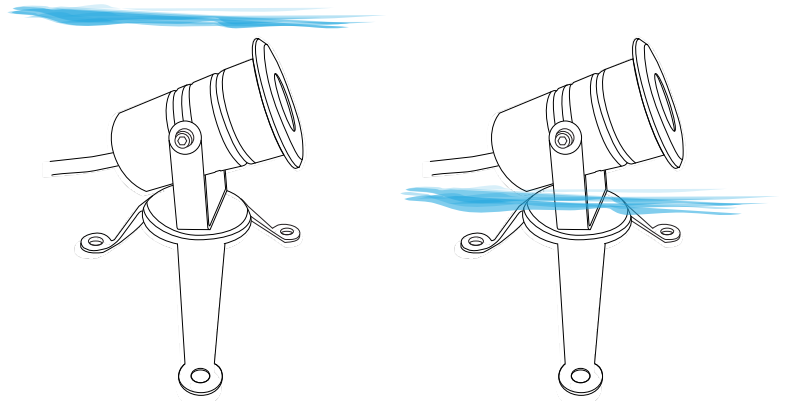

2. Secure Feet

Depending on surface, the tripod mount can be secured by stake or bolt.

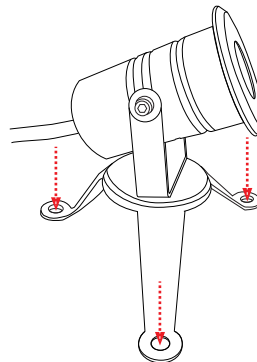

3. Angle Housing

Loosen hex nut with Allen wrench to adjust fixture for your perfect light angle and tighten to secure.

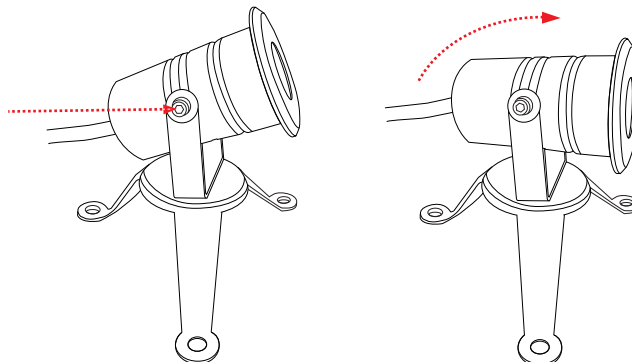

4. Connect to Controller and/or Power Supply

(See wiring diagrams)

IMPACT LIGHTING

2101 West Central Blvd. Orlando, Florida 32805 USA • Phone: 1.800.507.5714 • Email: sales@impactlightinginc.com

www.impactlightinginc.com

UX-50-T WIRING DIAGRAM

IP 68 UNDERWATER LED STAINLESS STEEL LIGHT FIXTURE

Connecting to Constant Current Power Supply

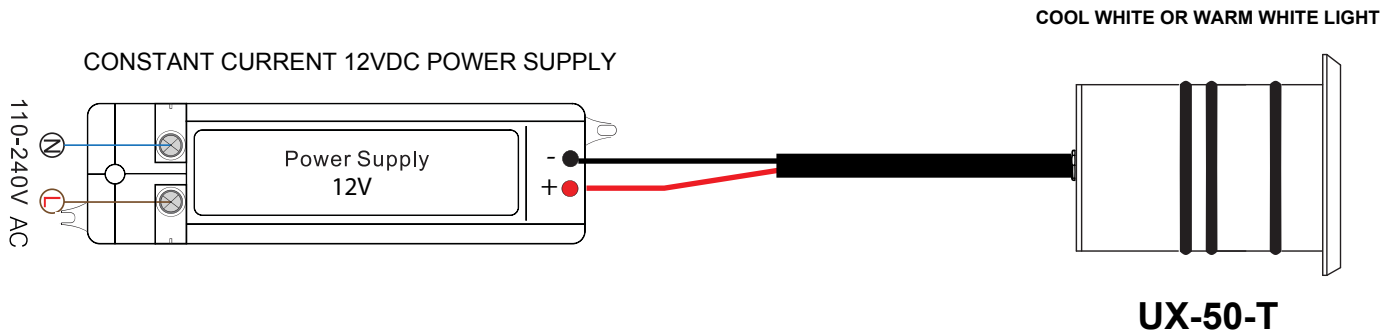

Connecting to DMX and Constant Current Power Supply

DMX SYSTEM WIRING

UX-50-1023-RGB-DMX
UX-50-1023-RGBW-DMX
UX-50-1023-WW-CW-DMX

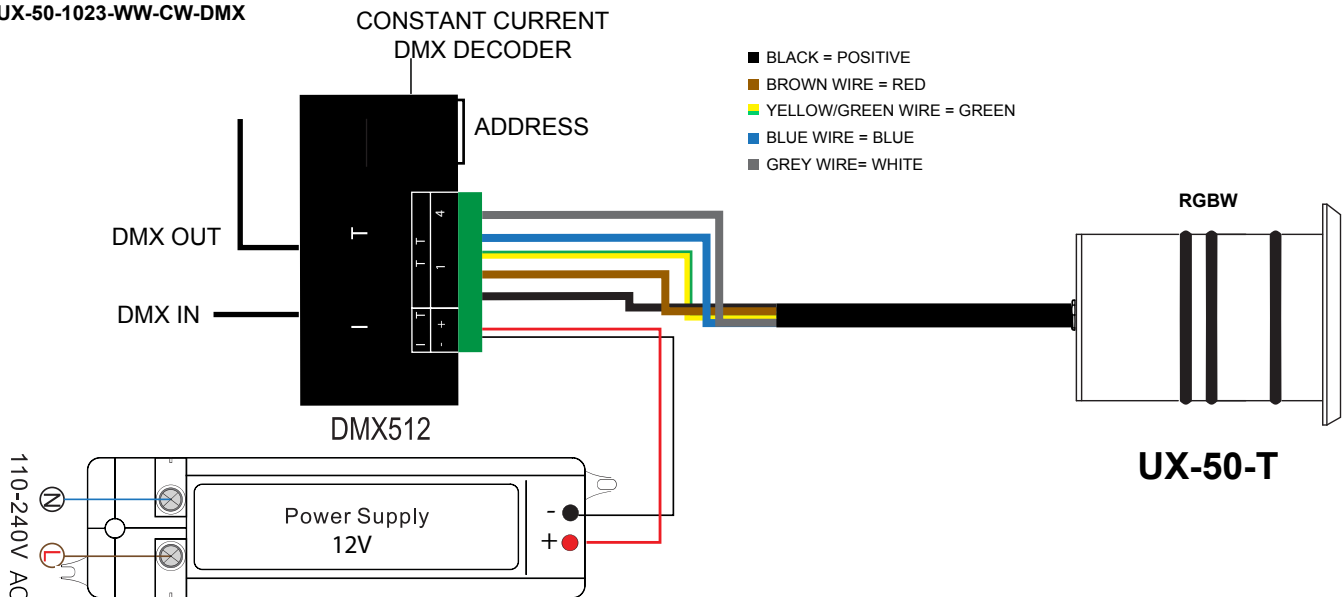

IMPACT LIGHTING

2101 West Central Blvd. Orlando, Florida 32805 USA • Phone: 1.800.507.5714 • Email: sales@impactlightinginc.com

www.impactlightinginc.com

UX-50-1023 INSTALLATION

IP 68 UNDERWATER LED STAINLESS STEEL LIGHT FIXTURE

READ AND FOLLOW INSTRUCTIONS CAREFULLY



THE UX-50 series are a low voltage light and should NEVER be electrically connected to a power source other than approved UL listed outdoor rated class 2 Transformer.
Failure to comply will either damage or destroy UX-50 lights and void the warranty.



1. Insert Into Fitting

NOTE: Requires the use of a 1 1/2" threaded wall fitting. 1.5" pipe through bond beam for a minimum of 14" then 1" conduit minimum with sweeps / no 90° bends. We highly recommend the use of a 1.5" pipe throughout the entire width of the bond beam.

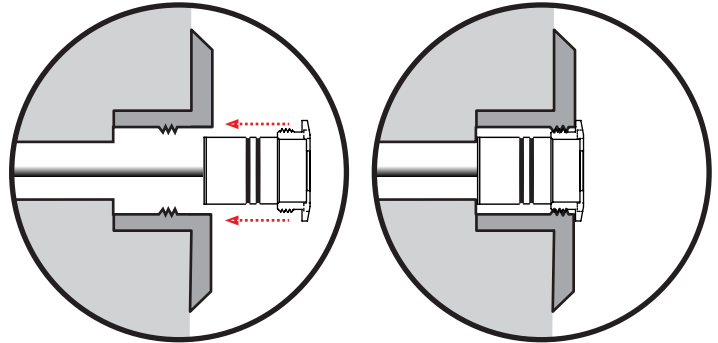

2. Feed Through Conduit Outlet

Snake the electric cord through the conduit outlet of the wall fitting into the conduit and up to the location of the 12VC constant current power supply. Cut off excess cord after allowing for service and length of run to the transformer. Pull the fixture snug to the wall fitting. 18"- 24" of excess cord recommended as service loop.

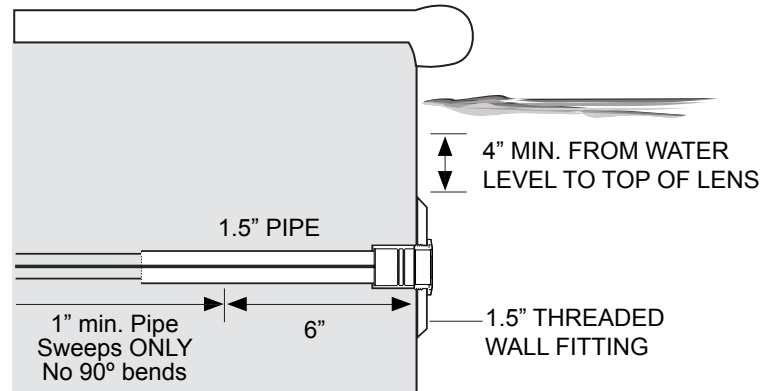

2. Tighten with Key

Using the enclosed Key, thread the light into the fitting until it is snug.

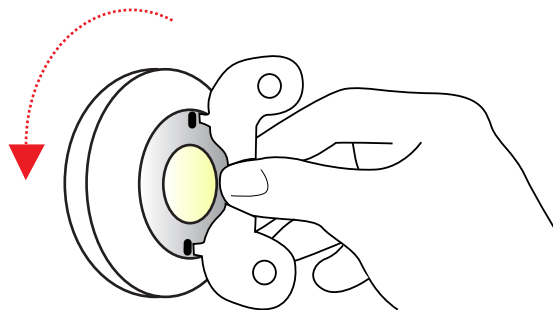

3. Connect to Controller and/or Power Supply

(See wiring diagrams)

IMPACT LIGHTING

UX-50-1023 WIRING DIAGRAM

IP 68 UNDERWATER LED STAINLESS STEEL LIGHT FIXTURE

Connecting to Constant Current Power Supply

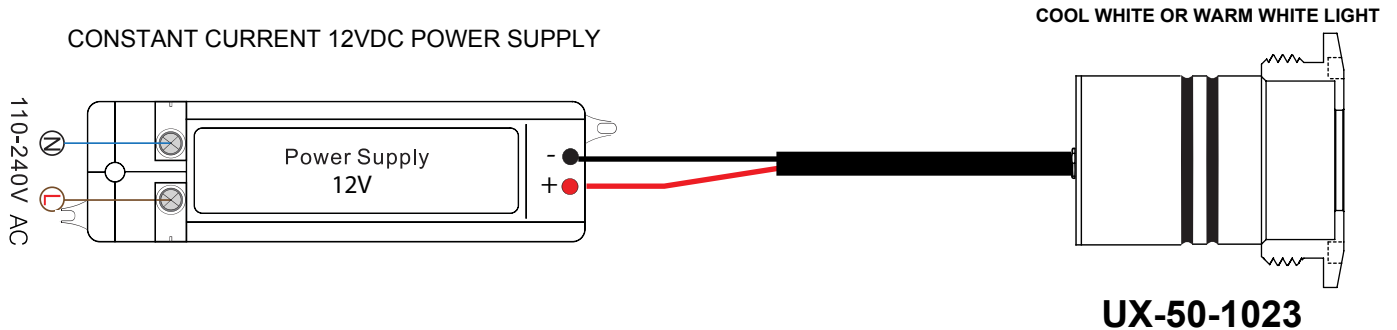

Connecting to DMX and Constant Current Power Supply

DMX SYSTEM WIRING

UX-50-1023-RGB-DMX
UX-50-1023-RGBW-DMX
UX-50-1023-WW-CW-DMX

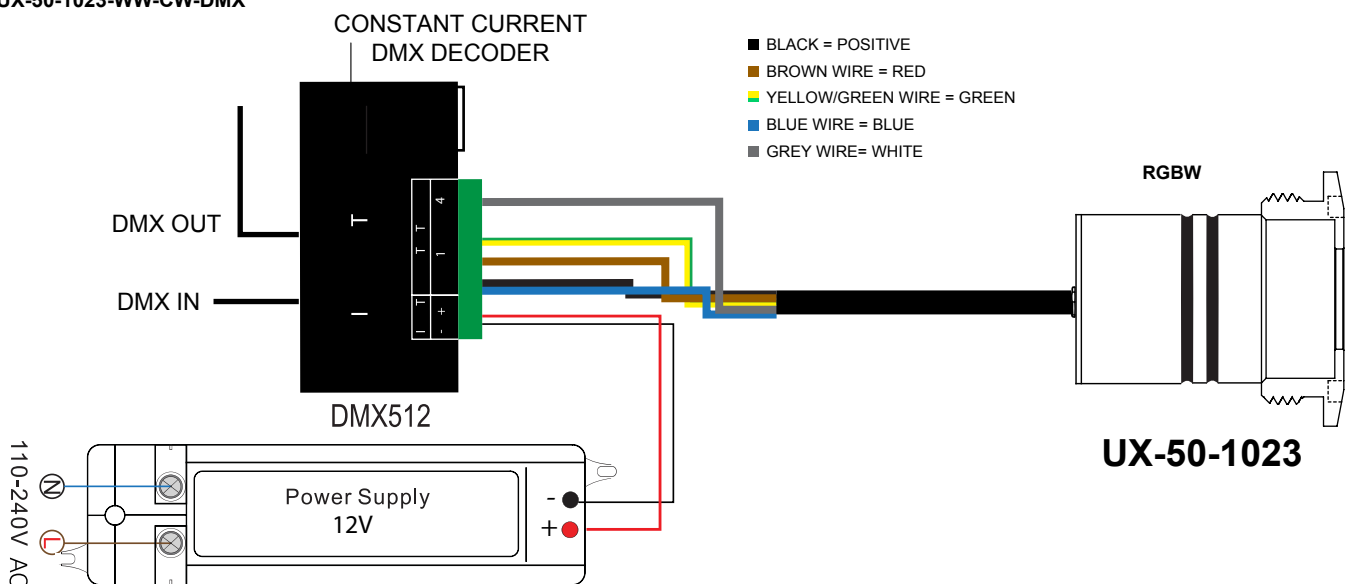

IMPACT LIGHTING

2101 West Central Blvd. Orlando, Florida 32805 USA • Phone: 1.800.507.5714 • Email: sales@impactlightinginc.com

www.impactlightinginc.com